



MEDIA-X-STELE. MEDIA STELE

DESIGN: WALTER KNOLL TEAM.

Versions	<p>Screen fixation: As standard, the stele is equipped with a monitor plate that will accept various screen brackets on site. As an option, the monitor plate is available for Cisco Webex boards with a wall mount.</p> <p>Top and middle front area:As standard, the bezels are designed without any functions.</p> <p>As an option, they can come in different designs</p> <ul style="list-style-type: none"> – loud speaker modules with fabric covering – customized camera screen – open shelf – flap <p>In general, the flap is equipped with electrification. The open compartment has this on request.</p> <p><i>Please note: Depending on the stel, various options are not available or are only available for individual fronts (for details, see the item)</i></p>	<p>The technical section is accessible from the front, through the lower front area. The technical section provides enough space for storing devices on site.</p> <p>Cabling: The various monitor plates and the technical section are provided with cable openings and options for routing cables.</p> <p>Ventilation: The air is exchanged through the gaps between the body and technical door as well as the large cable opening in the floor plate. Media stele with height adjustment: kiosks up to 70 and 85 inches are also available in a model with height adjustment. This allows presentations at different heights and makes it possible to transport the stele through normal doors/elevators.</p>
Function	<p>The stele stands on the floor and is attached to the wall with a tilt protection device. Available for screen sizes up to 55, 70, and 85 inches as well as for two separate screens of up to 55 inches each. The top and center front can be equipped with various options.</p>	<p>Screen fixation: As standard, the stele is equipped with a monitor plate that will accept various screens and brackets on site. For aesthetic reasons, we recommend using screens that are as flat as possible.</p> <p>As an option, the monitor plate is available for Cisco Webex boards with a wall mount.</p>
	Equipment	

When ordering, please keep in mind the maximum sizes, thicknesses, and weights of the relevant screens, including the brackets. The details can be found on the following pages next to the relevant detailed sketch.

Loud speaker modules: This speaker module is covered with charcoal-gray speaker fabric.

Camera tray: The camera tray is attached to the monitor plate from the rear and enables the integration of a camera above the monitor on-site. All monitor plates can accept the camera tray, which means that the camera tray can be retrofitted.

Finishes

The media stele are available in the following fine-texture paints:

- .104 fine-textured paint mineral
- .105 fine-textured paint white
- .106 fine-textured paint black
- .121 fine-textured paint greige

The floor plate always comes in Fenix that matches the selected fine-texture paint.

On the interior, the stel is the same color as the exterior.

Plug management

In general, the technical section is electrified. Please note the following country-specific equipment:

- 4x power socket - choose socket face
- L - 4x power socket - according to PSE norm (Japan)
- J - 1x thermal fuse, 3x power socket - according to SN SEV norm (Switzerland)
- B - 1x thermal fuse, 3x power socket - according to UL norm (North America)

Information

For the customized camera screen, exact information from the customer about the desired cutout is required. The feasibility of the customized camera screen model must absolutely be checked in advance – especially to prevent crushing and shearing points.

The aera at the front (top and center) can be switched upon request, even retroactively. Walter Knoll must check and offer this option on a case-by-case basis. (Color variations are possible)

MEDIA-X-STELE

Special conditions for Media Conferencing products.

media stele – suitable for up to 55 inch monitor (provided by customer)

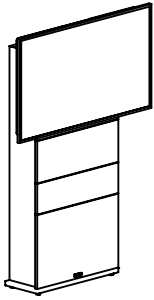

MS2420-010

B 111 T 32,5 H 180

media stele – suitable for up to 75 inch monitor (provided by customer)

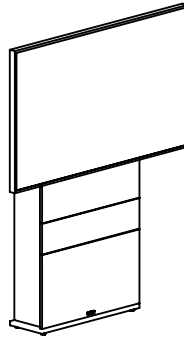

MS2420-020

B 126 T 32,5 H 198

media stele – suitable for up to 85 inch monitor (provided by customer)

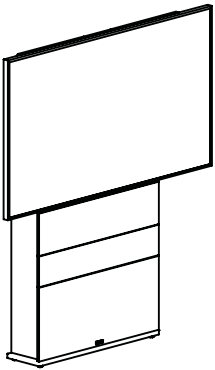

MS2420-030

B 150,5 T 32,5 H 219

media stele – suitable for up to 2 55 inch monitors (provided by customer)

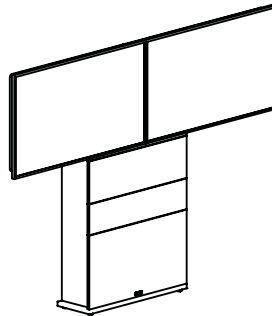

MS2420-040

B 236 T 32,5 H 180

MS2420-010

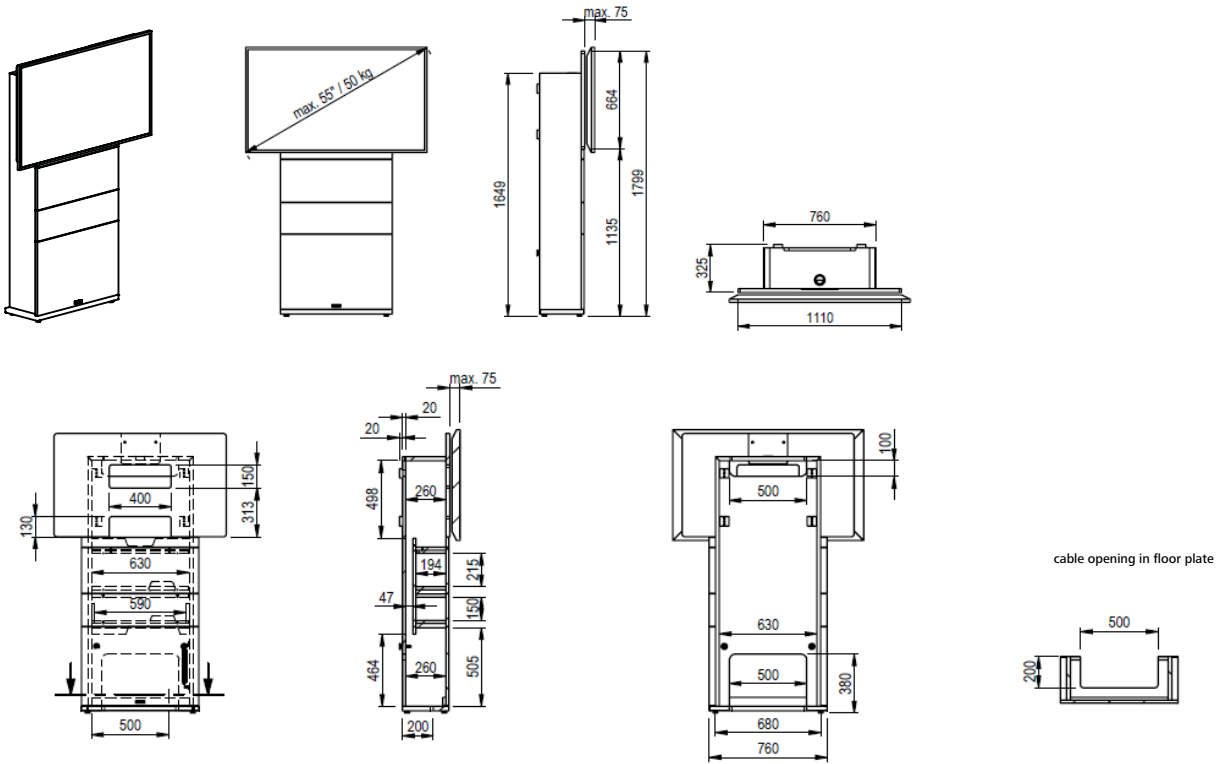

MS2420-020

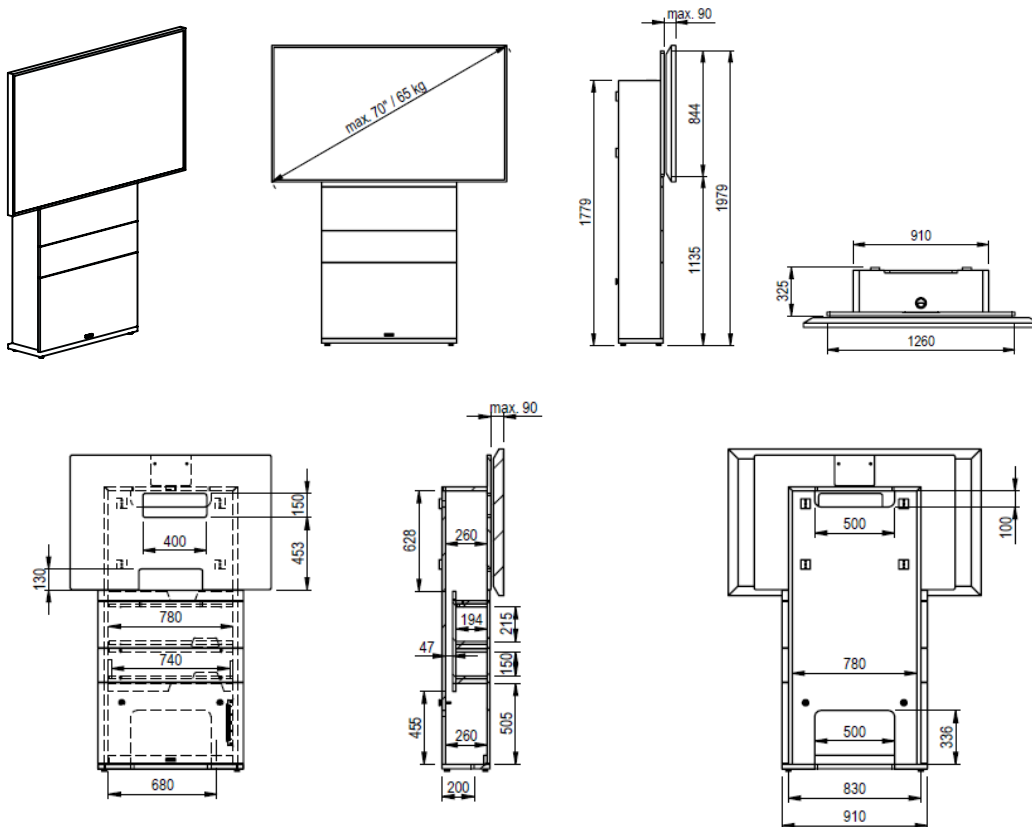

Freely available space dimensions for media technology integration

MS2420-030

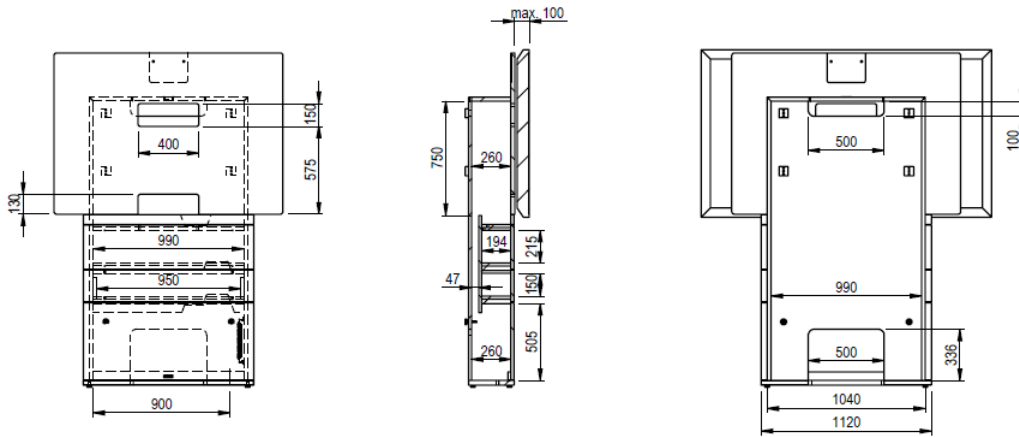
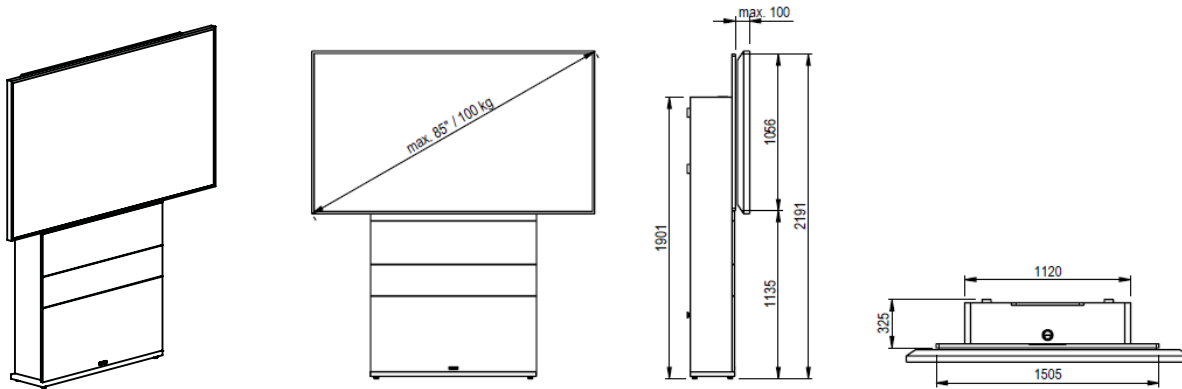

MS2420-040

